

SITE PLAN SHOWN IN FAVOR OF 1. SRI NIRENDRA NATH DAS,
 2.SRI SWAPAN KUMAR BISWAS , 3.SRI ARNAB KAR ,4.SMT SONALI CHAKRABORTY
 5.SUBHANGI DUTTA , 6.SRI SAYANTAN GHOSH . AT S.N. SEN ROAD .WARD NO - 05
 ,HOLDING NO -27. UNDER KRISHNANAGAR MUNICIPALITY,P.S -KOTWALI, KRISHNANAGAR
 DIST -NADIA , J.L NO-92 ,MOUZA - KRISHNANAGAR , R.S PLOT NO-14420/27034
 L.R PLOT NO - 10388 ,R.S KHATIAN NO- 5358, L.R KHATIAN NO
 -18792,53752,53753 (AS PER DEED) ,KHATIAN NO-55790 (AS PER PORCHA),
 LAND OF AREA-15.00 SATAK (AS PER DEED & PORCHA)
 LAND AREA- 14.93 SATAK (AS PER MEASUREMENT)

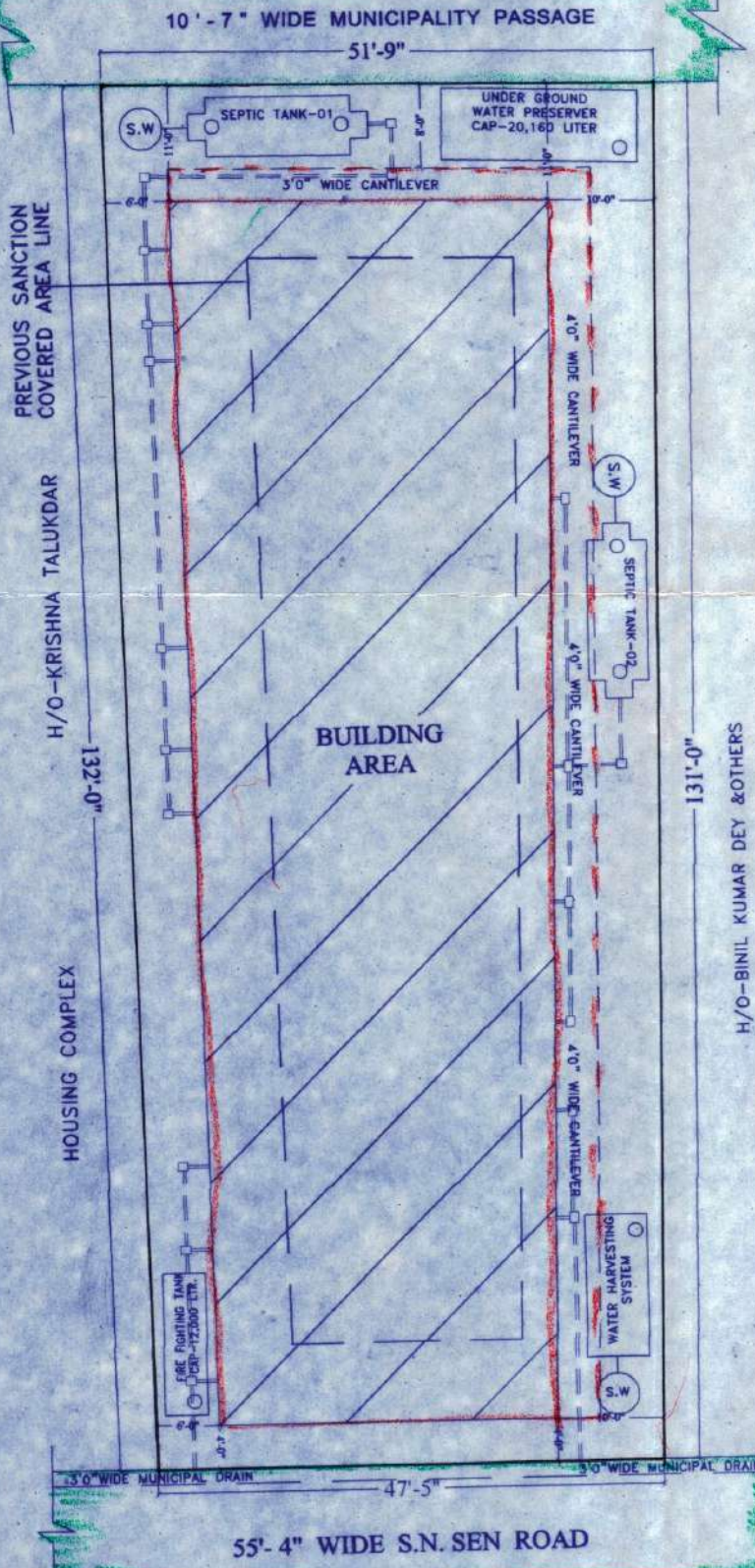

OWNER'S SIGNATURE -

- 1) Nirendra Nath Das,
- 2) Swapan Kumar Biswas
- 3) Arnab Kar.
- 4) Sonali Chakraborty
- 5) Subhangi Dutta
- 6) Sayantan Ghosh.

L.B.S ENGINEER'S SIGNATURE-

Prasanta Ghosh
 Prasanta Ghosh, L.C.E.
 Anadinagar, Krishnagar
 L.B.S. of P.G. Municipality
 Regn. No. -162001-2002K.M.

STRUCTURAL ENGINEER'S SIGNATURE-

Avik Biswas
 MR. AVIK BISWAS
 L.B.S-CLASS-I
 REG NO-03/2018-2019KM.
 STE-CLASS-I
 REGNO-01/2023-2024 KM.
 GTE-CLASS-I
 REGNO-01/2023-2024 KM
 SASITITALA, KRISHNANAGAR, NADIA

SITE PLAN
 SCALE- 1:137